

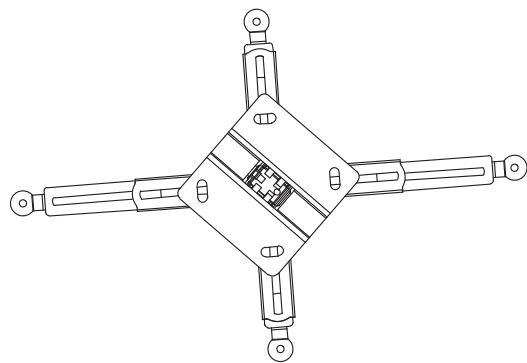

ИНСТРУКЦИЯ ПО МОНТАЖУ

CS-VM-PREC01

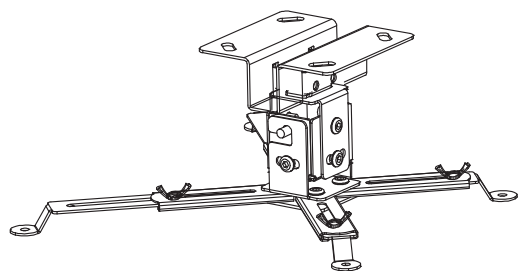

20 кг макс.

▶ **НЕОБХОДИМЫЕ ИНСТРУМЕНТЫ,
НЕ ВХОДЯЩИЕ В КОМПЛЕКТ ПОСТАВКИ**



▶ **НЕОБХОДИМЫЕ ИНСТРУМЕНТЫ, ВХОДЯЩИЕ В КОМПЛЕКТ ПОСТАВКИ**

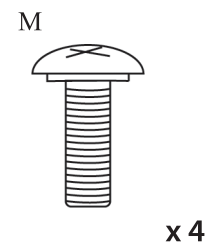
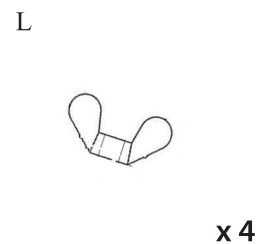
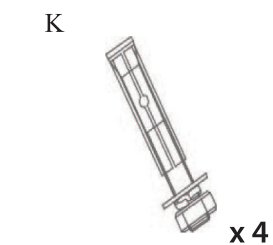
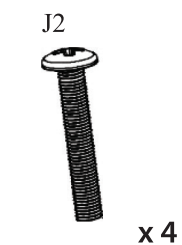
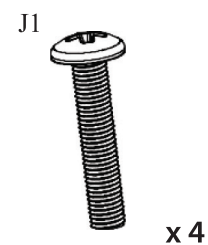
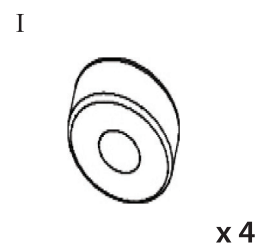
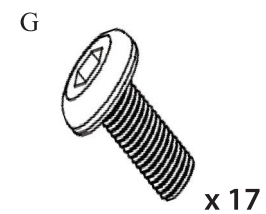
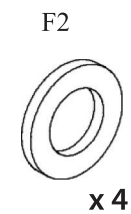
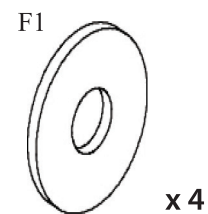
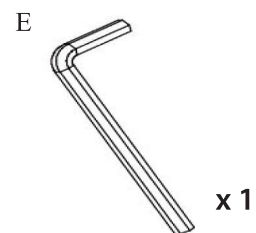
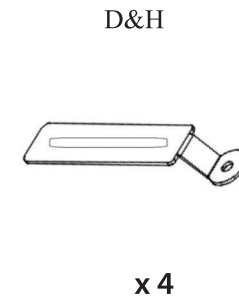
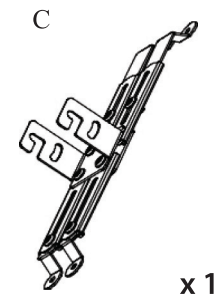
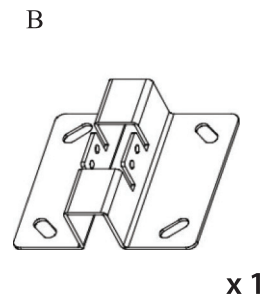
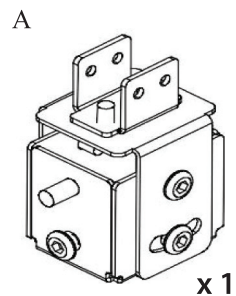

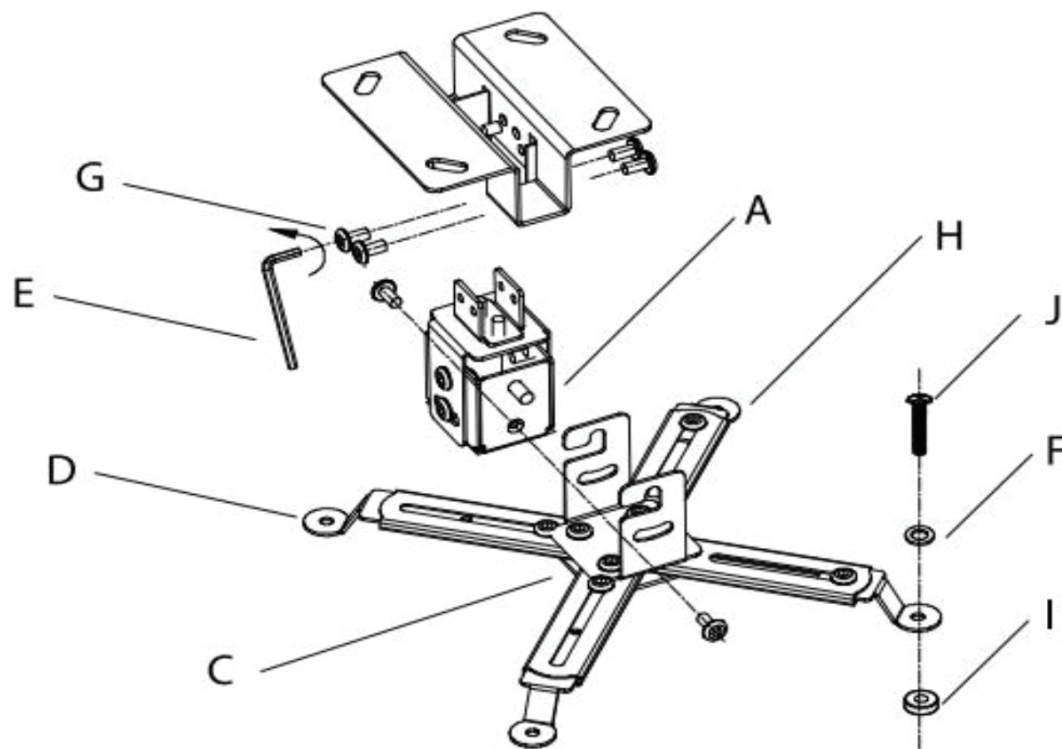
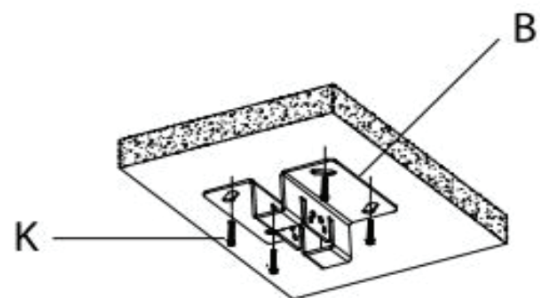

Данный кронштейн с прилагаемым крепежом необходимо устанавливать только на бетонные или кирпичные потолки или стены.